

VICINITY MAP - NOT TO SCALE

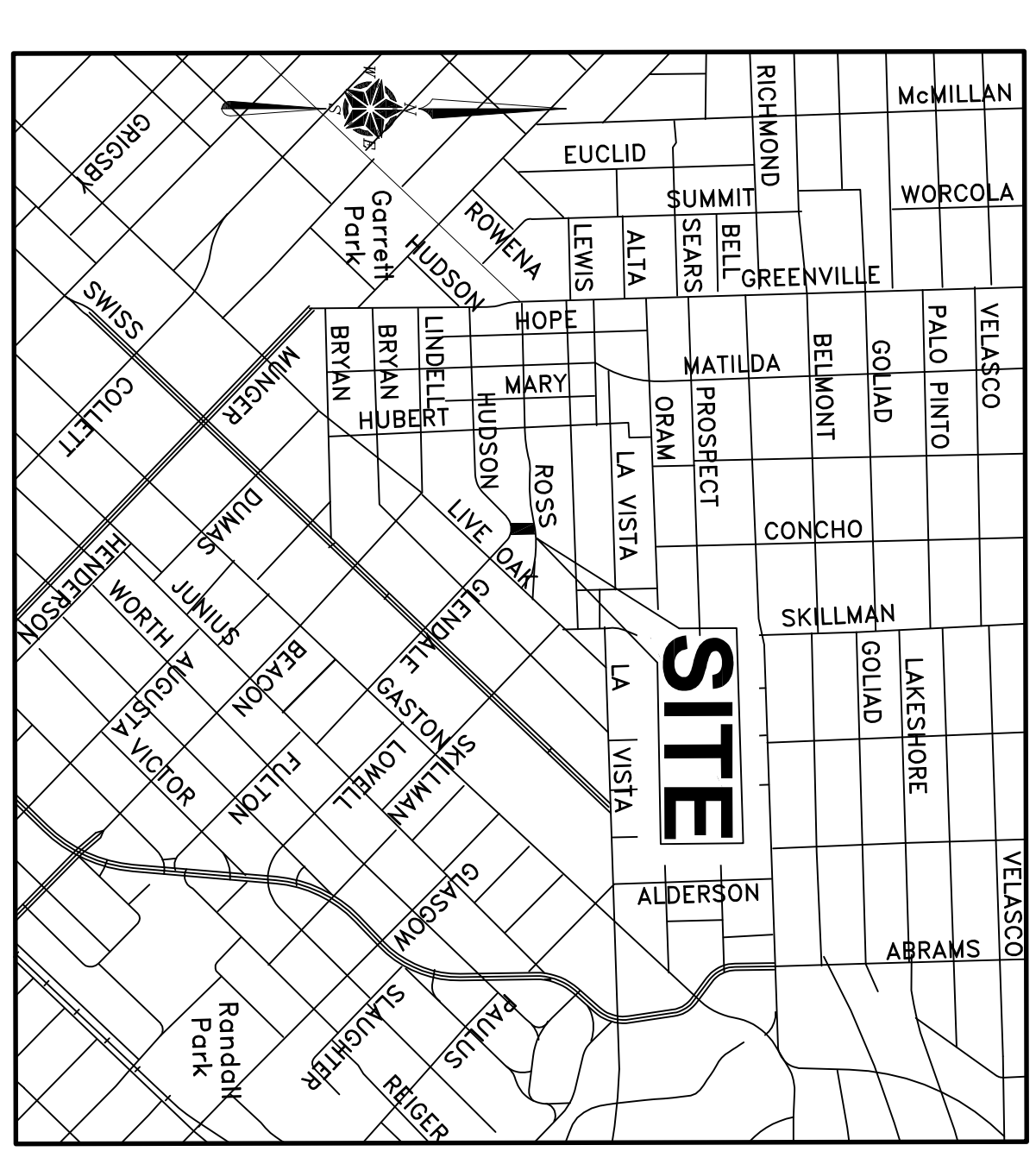

PRELIMINARY. THIS DOCUMENT SHALL NOT BE RECORDED FOR ANY PURPOSES AND SHALL NOT BE USED OR VIEWED OR RELIED UPON AS A FINAL SURVEY DOCUMENT. (08/11/2020)

GENERAL NOTES:

- 1) BEARINGS ARE BASED UPON THE TEXAS STATE PLANE COORDINATE SYSTEM, NORTH CENTRAL ZONE, NORTH AMERICAN DATUM OF 1983. (2011)
- 2) THE PURPOSE OF THIS PLAT IS TO PLAT LOT FROM 1 TRACT OF LAND SECTION APPROVAL.
- 3) LOT-TO-LOT DRAINAGE WILL NOT BE ALLOWED WITHOUT ENGINEERING SECTION APPROVAL.
- 4) ACCORDING TO THE FIRM, PANEL NO. 481192038K, THE SUBJECT PROPERTY LIES IN ZONE X AND DOES NOT JEOPARDIZE A FLOOD PRONE HAZARD AREA.
- 5) COORDINATES SHOWN ARE STATE PLANE COORDINATE SYSTEM NORTH CENTRAL ZONE, NORTH AMERICAN DATUM OF 1983 ON GRID COORDINATE VALUES, NO SCALE AND NO PROJECTION.
- 6) DALLAS WATER UTILITIES BENCHMARK 36-K-451 SWDBM ON CONCRETE CURB OF STORM SEWER DROP INLET, SOUTHWEST CORNER OF THE INTERSECTION OF GLENDALE AND LIVE OAK STREET, NORTHINGS: 6392.097141; EASTINGS: 2501.918388; ELEVATION: 520.02
- 7) DALLAS WATER UTILITIES BENCHMARK 36-K-551 SWDBM ON CONCRETE CURB OF STORM SEWER DROP INLET, SOUTHEAST CORNER OF THE INTERSECTION OF LIVE OAK STREET AND SKILLMAN STREET, NORTHINGS: 6392.687545; EASTINGS: 2502.493494; ELEVATION: 524.11'
- 7) THERE ARE NO EXISTING STRUCTURES ON THE SUBJECT PROPERTY.

LEGEND

- D.R.D.C.T. DEED RECORDS, DALLAS COUNTY, TEXAS
- M.R.D.C.T. MAP RECORDS, DALLAS COUNTY, TEXAS
- INST. NO. INSTRUMENT NUMBER
- VOL. PG. VOLUME PAGE
- SQ. FT. SQUARE FEET
- RP. ROAD RIGHT-OF-WAY
- IR. IRON ROD FOUND
- 3.04" METAL DISC STAMPED "LAGUNA ON HUDSON & P.S. 6298"
- SET FOR CORNER
- SMH SANITARY SEWER MANHOLE
- SDWH STORM DRAIN MANHOLE
- COO CLEAN OUT
- WM WATER METER
- ICVD IRRIGATION CONTROL VALVE
- R.O.W. RIGHT-OF-WAY
- R CURVE RADIUS
- L CURVE LENGTH
- OHPS OVERHEAD POWER SERVICE
- OHPS OVERHEAD POWER LINE
- SS SANITARY SEWER LINE
- W WATER LINE
- GS GAS LINE

PRELIMINARY PLAT
LAGUNA ON HUDSON

LOT 10, BLOCK H/1877
A PORTION OF CITY BLOCK 1877
ROBERT RAY SURVEY, ABSTRACT NO. 1242
CITY OF DALLAS, DALLAS COUNTY, TEXAS
CITY PLAN FILE NO. S-190-142

OWNER
Laguna Homes, Inc.,
a Texas Corporation
440 WHITE OAK CIRCLE
ANNA, TEXAS 75409-7042

SURVEYOR
TEXAS HERITAGE
SURVEYING, LLC
10610 Mettlic Drive, Suite 124, Dallas, TX 75243
Office 214-340-9700 Fax 214-340-9710
kheritage.com
Firm #10109500



DATE: 04/15/2020 / JOB # 2000709-1 / SCALE - 1"=20' / NO
PAGE 1 OF 2

